



TRS.ETMB

THREEAXIAL ANGULAR SAFETY SENSOR



- Double CPU and a double 3D MEMS accelerometer, in a fully redundant circuit scheme, with a safety-based relay output switch
- Logic output software configurable
- Differentiates the X-, X+, Y-, Y+ axes as well as to get separate offset
- Implementable as a SLAVE in a CAN network
- Polyurethane resin case



#### TECHNICAL FEATURES

MASTER CODE		TRS.ETMB
POWER SUPPLY		9-36 VDC / CURRENT CONSUMPTION 30 mA AT 24 VDC (STAND BY MODE)
		2 SAFETY RELAY DIGITAL ON/OFF TRIGGER OUTPUT
		REDUNDANT OUTPUT CIRCUIT SCHEME
OUTPUT		OUTPUT CURRENT: MAX 2 A
		4 INDEPENDENT THRESHOLD ANGLES SETUP (X-, X+, Y-, Y+)
		THRESHOLD PROFILE WINDOW: RECTANGULAR OR TOROIDAL
CAN BUS	1 PORT	2.0B COMPLIANT - (11, 29 BIT) - ISO 11898 - UP TO 1MBIT/S
CAN BUS PROTOCOLS		CAN OPEN (CIA DS410 DEVICE PROFILE FOR INCLINOMETER, WITH DS306 COMPLIANT EDS FILE)
LED		NR.1 STATUS LED
MEASURE OPTIONS		TILT / ANGLE
TECHNOLOGY		3D MEMS ACCELEROMETER
SAFETY		DOUBLE CPU AND DOUBLE SENSOR
CONNECTION PORT	1	0,60 m CABLE TPE 0,50 m CABLE PUR WITH 8 POLES DEUTSCH CONNECTOR
CASE		ENCAPSULATED IN PUR RESIN - SELF-EXTINGUISHING UL94 (V0)
WORKING TEMPERATURE		-40°C +80°C



(25/06/2025) - 1



TRS.ETMB

THREEAXIAL ANGULAR SAFETY SENSOR

MEASURE FEATURES

OPTIONS	ANGLE – TILT
FILTERING	USER CONFIGURABLE
RESOLUTION	UP TO 0,01°
REDUNDANCY DIFFERENCE MEASURE	LESS THAN 1°

ELECTRONIC FEATURES

SLAVE USAGE	EDS FILE
PROGRAMMING	FIRMWARE UPLOAD BY CAN BUS WITH ALOADER SOFTWARE TOOL
CONFIGURING	THROUGH ALTILT CONFIG
CPU	DOUBLE 16 bit MICROCONTROLLER CORE
SAMPLE TIME	LESS THAN 5 ms

STANDARDS

ELECTROMAGNETIC EMISSIONS	EN 61000-6-4// EN 55011 (RF RADIATE)
---------------------------	--------------------------------------

ELECTROMAGNETIC IMMUNITY	EN 61000-6-2// EN 61000-4-2/3/4/6
--------------------------	-----------------------------------

IP	BOX: IP68
----	-----------

MTTFd	96,86 YEARS CALCULATED ACCORDING TO THE IEC61709 (SIEMENS SN29500), WITH ENVIRONMENTAL FACTORS 3K7 (IEC60721) RATED RELAY CYCLES: 20000/YEAR
-------	---

PERFORMANCE AND SAFETY INTEGRITY LEVEL	PLd – SIL2 (DUAL-CHANNEL INTERNAL SCHEME)
--	--

IN ACCORDANCE WITH THE EN50498 THE DEVICE MEETS THE TECHNICAL SPECIFIC REQUIREMENTS OF 2004-104 DIRECTIVE (AUTOMOTIVE). THE DEVICE IS EMC 2004/108 COMPLIANT.

SIZE (mm)

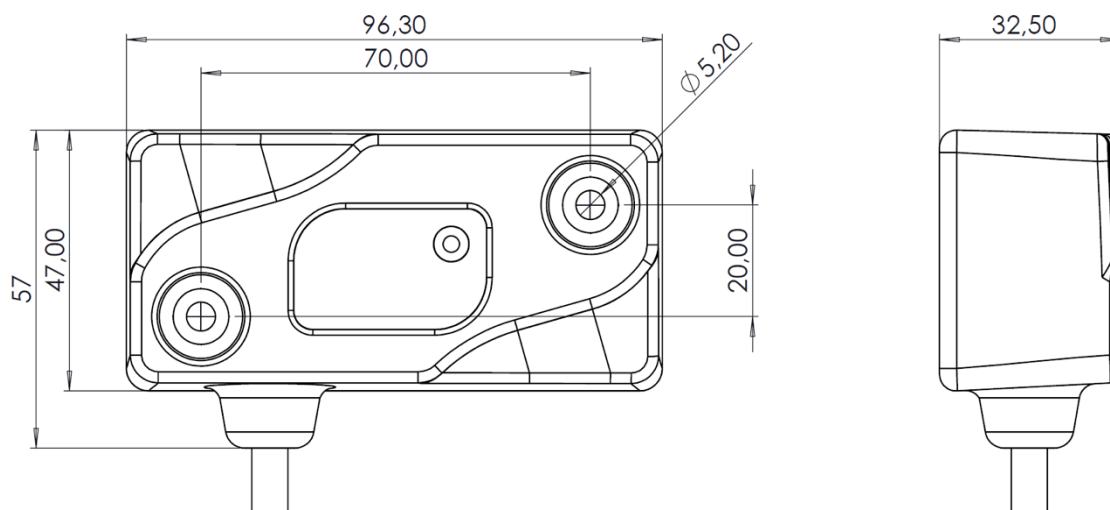



TRS.ETMB

THREEAXIAL ANGULAR SAFETY SENSOR

CONNECTION OPTIONS

CABLE: PUR , 0,50m LENGTH

CONNECTOR: DEUTSCH DT04-8P



1	BN	POSITIVE POWER SUPPLY
2	WH	GND POWER SUPPLY
3	YE	CAN L
4	OR	CAN H
5	BU	OUTPUT R3
6	BK	OUTPUT R2
7	VT	ZERO
8	GY	POSITIVE COMMON POWER SUPPLY R1

CABLE: TPE , 0,60m LENGTH

\*TWISTED WIRES ON COLOUR COUPLES

CONNECTOR: n.a.



*	BN	POSITIVE POWER SUPPLY
	WH	GND POWER SUPPLY
*	YE	CAN L
	GN	CAN H
*	BU	OUTPUT R3
	RD	OUTPUT R2
*	PK	ZERO
	GY	POSITIVE COMMON POWER SUPPLY R1

OUTPUT FEATURES

OUTPUT CIRCUIT SCHEME

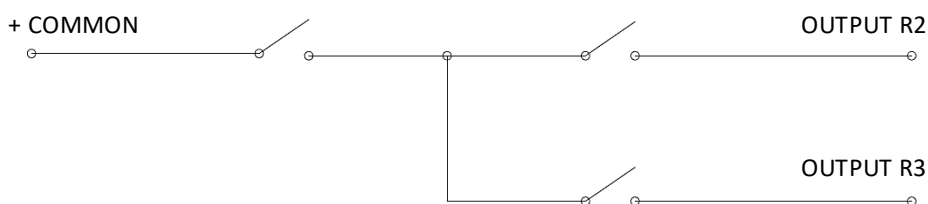

MEASURE OPTIONS

S00

TRASDUCER WITH FULLY CONFIGURABLE  
ANGLE MEASUREMENT MODE AND  
FILTERS SETUP



S01

TRASDUCER WITH ANGLE MEASUREMENT  
MODE ONLY ON Z AXIS (ANGLE  
MEASUREMENT)



S04

TRASDUCER WITH ANGLE MEASUREMENT  
MODE ON X & Y AXIS  
(TILT MEASUREMENT)

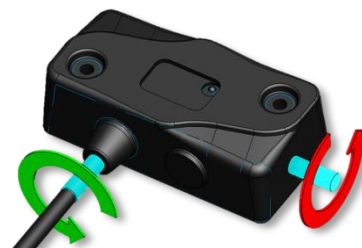



NOTE